



PERCUSSIVE ARTS SOCIETY INTERNATIONAL CONVENTION

**Concert Chamber
Percussion Ensemble Competition**

Load-In and Load-Out procedures:

Dock Yard: Must unload trucks on tarmac and push gear up **Ramp B** into Hall B in time to report for your scheduled warm-up time. After warm-up, you will move out of Hall B into the hallway west of Room 125 entrance for staging. Immediately following your performance, you will move out of Room 125, to Hall B, then down **Ramp A** returning to the dock yard to load up. **You may load-in only immediately prior to your scheduled warm-up. PAS does not provide storage for instruments.**

Note: Small Ensembles it will be easier to load into the front of the Indiana Convention Center off of Maryland Street. There is a carport/pull-up that can be used to quickly unload instruments if needed (No parking allowed, though). The docks can be accessed and used if needed.

Inclement Weather Plan:

All individuals and ensembles have specific, assigned warm-up rooms, so there should not be any need to warm-up outside the Convention Center. Weather, therefore, is not a factor as it relates to warm-ups.

Equipment Truck:

Equipment trucks should unload at the Indiana Convention Center loading dock tarmac off of West Street. There will only be a limited space for equipment trucks on the tarmac. We strongly encourage you to stress to your students that upon arriving or after their performance, your equipment truck must be loaded/unloaded quickly. With limited space and several ensembles competing, we need to be extremely efficient with our load-out procedure. After your truck is loaded, you **MUST** move it to a parking lot.

Buses:

On Friday, buses should unload students outside the dock area gates on West Street. Buses cannot park there – they may Un-load only. Please have your students/parents organized to unload/load quickly.

Indianapolis Parking Lot Map:

Please see the enclosed downtown parking lot map. Each group is responsible for finding their own parking. There are five recommended open-air parking lots that are within a couple of blocks of the convention center. These are pay-to-park-lots.

Walk-through:

There will not be a guided walk-through of the competition area and warm-ups. PAS staff will be available to discuss the load-in area, warm-up area, performance hall, load-out and the flow of the competition floor on Wednesday and Thursday. If you have any updates to your copyright or spiel sheet, please bring that to the PASIC Show Office. Please note: You will not be able to perform if you do not have the proper copyright forms on file with PAS. This does not apply to individuals or groups performing an original work.

STAFF & CREW— All staff and crew attendees must have a pass or wristband for entry.

Ensembles that participate in the Concert Chamber Percussion Ensemble Competition will receive one complimentary Limited One-Day Wristband. Anyone traveling with the group may help move, set, and strike gear to and from the performance area, but must have a pass or wristband. Staff and Crew members only interested in attending the Concert Chamber Percussion Ensemble Competition, Marching Percussion Festival and the International Drum and Percussion Expo on Friday may purchase Limited One-Day Wristbands for \$25 each. Staff and Crew members who would like to purchase a Four-Day Pass or a One-Day Pass should contact PAS.

ACCOMPANYING FAMILY MEMBERS**All attendees must have a pass or wristband for entry.**

Family members only interested in attending the Concert Chamber Percussion Ensemble Competition, Marching Percussion Festival and the International Drum and Percussion Expo on Friday may purchase Limited One-Day Wristbands for \$25 each. Family members may purchase Four-Day Passes for \$95 or One-Day Passes for \$60 onsite or in advance. Both passes allow access to all PASIC activities.

QUESTIONS?

Please contact Programs Manager, Amber Fox: afox@pas.org.

GROUP SCHEDULE - FRIDAY NOVEMBER 16, 2018

Performance Times:

Please review your performance time, performance requirements, as well as the total interval time allotted for entrance, performance, and exit.

08:55 a.m. Introduction of judges and about the contest

High School Judges: Brian Blume, Joe Hobbs, Lauren Teel

	Warm-up Hall B	Ready Hallway	Perform
John S. Battle High School - Group 3	08:20 a.m.	08:50 a.m.	09:00 a.m.
Father Ryan High School	08:35 a.m.	09:05 a.m.	09:15 a.m.
West Clermont High School	08:50 a.m.	09:20 a.m.	09:30 a.m.
Spring Hill High School	09:05 a.m.	09:35 a.m.	09:45 a.m.
Jeffersonville High School	09:20 a.m.	09:50 a.m.	10:00 a.m.
Lawrence Township	09:35 a.m.	10:05 a.m.	10:15 a.m.
Okemos High School	09:50 a.m.	10:20 a.m.	10:30 a.m.
Campbell County High School - Group 2	10:05 a.m.	10:35 a.m.	10:45 a.m.
Break			
Campbell County High School - Group 1	10:35 a.m.	11:05 a.m.	11:15 a.m.
Center Grove High School	10:50 a.m.	11:20 a.m.	11:30 a.m.
Blue Valley West High School - Group 2	11:05 a.m.	11:35 a.m.	11:45 a.m.
John S. Battle High School - Group 2	11:20 a.m.	11:50 a.m.	12:00 p.m.
Blue Valley West High School - Group 1	11:35 a.m.	12:05 p.m.	12:15 p.m.
Middleton High School	11:50 a.m.	12:20 p.m.	12:30 p.m.
John S. Battle High School - Group 1	12:05 p.m.	12:35 p.m.	12:45 p.m.
Orange County High School	12:20 p.m.	12:50 p.m.	01:00 p.m.

01:30 p.m. High School Division Awards

University Judges: Thomas Burritt, Dave Hall, Julie Hill

	Warm-up Hall B	Ready Hallway	Perform
Kent State University	01:20 p.m.	01:50 p.m.	02:00 p.m.
Cal State - Long Beach	01:35 p.m.	02:05 p.m.	02:15 p.m.
Truman State University	01:50 p.m.	02:20 p.m.	02:30 p.m.
University of Oklahoma	02:05 p.m.	02:35 p.m.	02:45 p.m.
University of Texas at Austin	02:20 p.m.	02:50 p.m.	03:00 p.m.
University of Memphis	02:35 p.m.	03:05 p.m.	03:15 p.m.
University of North Alabama	02:50 p.m.	03:20 p.m.	03:30 p.m.
Messiah College	03:05 p.m.	03:35 p.m.	03:45 p.m.
Break			
Harding University	03:35 p.m.	04:05 p.m.	04:15 p.m.
University of Texas Rio Grande Valley	03:50 p.m.	04:20 p.m.	04:30 p.m.
Western Carolina University	04:05 p.m.	04:35 p.m.	04:45 p.m.
Iowa State University	04:20 p.m.	04:50 p.m.	05:00 p.m.
Virginia Commonwealth University	04:35 p.m.	05:05 p.m.	05:15 p.m.
Quachita Baptist University	04:50 p.m.	05:20 p.m.	05:30 p.m.
University of North Florida	05:05 p.m.	05:35 p.m.	05:45 p.m.
Lamont School of Music University of Denver	05:20 p.m.	05:50 p.m.	06:00 p.m.

06:30 p.m. University Division Awards & Closing Comments

Chamber Ensemble Load-In and Load-Out (Friday only)

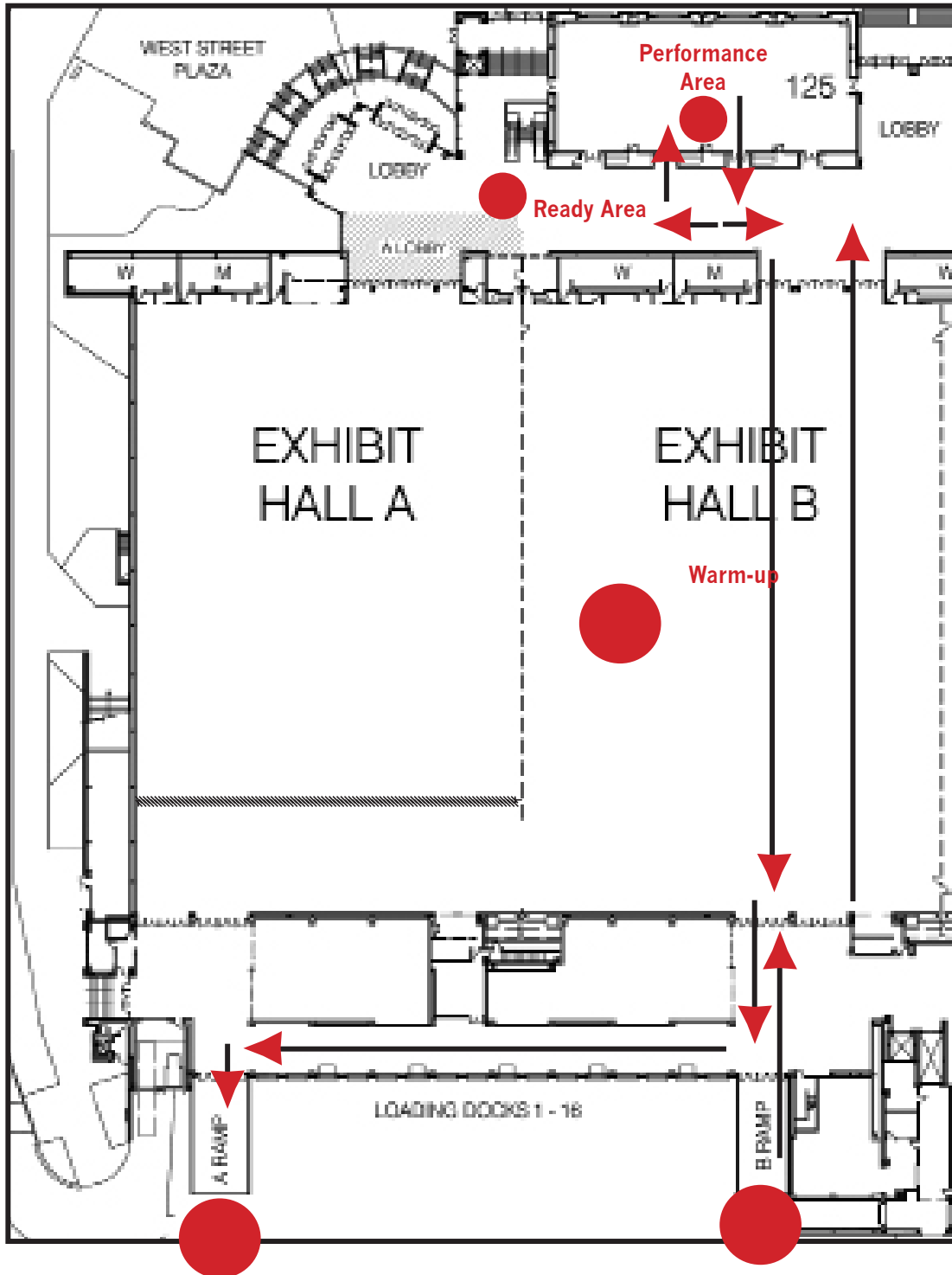

Load into Hall B via Ramp B.

Move from Hall B into hallway, west of the entrance to Room 125.

Load out back through Hall B, then down Ramp A

Chamber Percussion Ensemble Load In/Out (Friday only)

Performance Room: 125

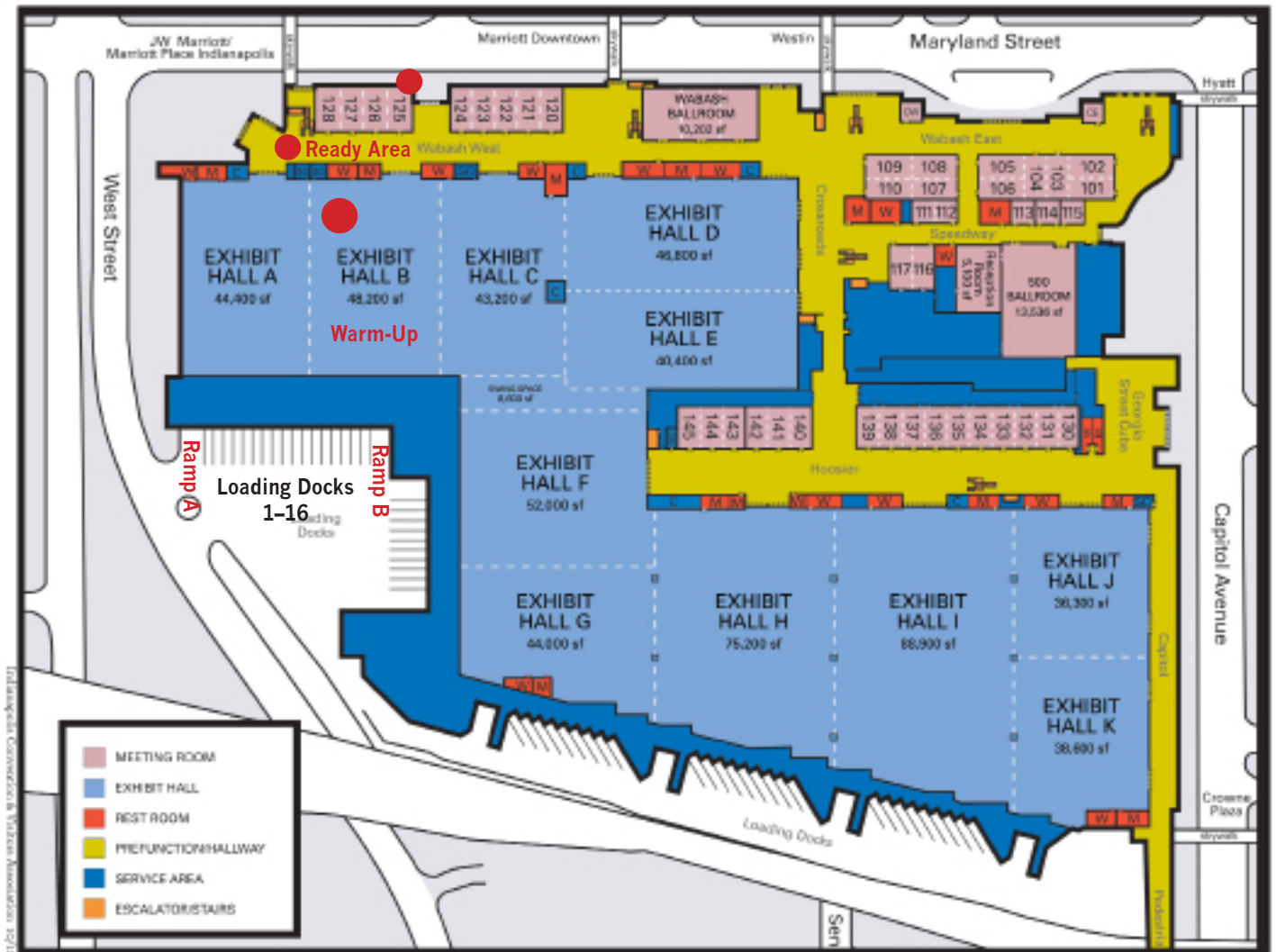

In order to keep the docks and ramps open to all, no parking is permitted in the loading dock area. Move your vehicle immediately after you unload for warm-up. Following your performance, please load-out and move your vehicle to one of the designated lots on the enclosed downtown parking map.

Parking is at your own expense.

- parking garage
- open lot for truck

